

UTILITY NOTES:

1. SANITARY

1.1 MATERIALS

- LATERALS - PIPING SHALL BE POLYVINYL CHLORIDE (PVC) WITH ENDS SUITABLE FOR ELASTOMERIC GASKET JOINTS, AND A MINIMUM WALL THICKNESS OF SDR-21. PIPING AND FITTINGS SHALL MEET ASTM D-2241.
- JOINTING MATERIALS - SHALL BE BELL-AND-SPOUT WITH INTEGRAL PUSH ON TYPE ELASTOMERIC GASKET JOINTS, GASKET MATERIAL TO BE NEOPRENE MEETING ASTM D-3212.

1.2 INFILTRATION/ EXFILTRATION - MAXIMUM ALLOWABLE INFILTRATION OR EXFILTRATION SHALL NOT EXCEED 100 GALLONS PER INCH DIAMETER PER MILE OF PIPE PER DAY FOR THE SANITARY SEWER. IF AN AIR TEST IS USED, THE TEST AS A MINIMUM SHALL CONFORM TO THE PROCEDURE DESCRIBED IN ASTM F1417 ENTITLED STANDARD PRACTICE FOR INSTALLATION ACCEPTANCE OF PLASTIC NON-PRESSURE SEWER LINES USING LOW-PRESSURE AIR. SANITARY MANHOLES SHALL BE VISUALLY INSPECTED AND TESTED FOR LEAKAGE BY EX FILTRATION OR VACUUM. VACUUM TESTING OF MANHOLES SHALL COMPLY WITH THE METHOD OUTLINED IN THE NEW YORK STATE DEPARTMENT OF ENVIRONMENTAL CONSERVATION TECHNICAL INFORMATION PAMPHLET (TIP) NO. 15 (REVISED).

1.3 FLOOR DRAINS - FLOOR DRAINS, IF CONSTRUCTED IN THE PROJECT, MUST BE CONNECTED TO THE SANITARY SEWER. NOTE: FLOOR DRAINS DO NOT INCLUDE FOUNDATION OR FOOTER DRAINS INSTALLED TO INTERCEPT UNCONTAMINATED GROUND WATER. ALL DISCHARGES FROM THE FLOOR DRAINS TO THE SANITARY SEWER MUST COMPLY WITH THE EFFLUENT LIMITS OF THE LOCAL AND/OR THE MONROE COUNTY SEWER USE LAW.

1.4 TESTING - DEFLECTION TESTS SHALL BE PERFORMED ON ALL FLEXIBLE PIPE. THE TEST SHALL BE CONDUCTED AFTER THE FINAL BACKFILL HAS BEEN IN PLACE AT LEAST 30 DAYS. NO PIPE SHALL EXCEED A DEFLECTION OF 5% OF THE DEFLECTION TEST IS TO BE RUN USING A RIGID BALL OR MANDREL. IT SHALL HAVE A DIAMETER EQUAL TO 95% OF THE INSIDE DIAMETER OF THE PIPE. THE TEST SHALL BE PERFORMED WITHOUT MECHANICAL PULLING DEVICES.

1.5 SEPARATION - MINIMUM VERTICAL SEPARATION BETWEEN WATER MAINS AND SEWER LINES SHALL BE 18 INCHES MEASURED FROM THE OUTSIDE OF THE PIPES AT THE POINT OF CROSSING. ONE FULL STANDARD LAYING LENGTH OF WATER MAIN SHALL BE CENTERED UNDER OR OVER THE SEWER SO THAT BOTH JOINTS WILL BE AS FAR FROM THE SEWER AS POSSIBLE. IN ADDITION, WHEN THE WATER MAIN PASSES UNDER A SEWER, ADEQUATE STRUCTURAL SUPPORT (COMPACTED SELECTED FILL) SHALL BE PROVIDED FOR THE SEWER TO PREVENT EXCESSIVE DEFLECTION OF JOINTS AND SETTLING OF THE SEWER ON THE WATER MAIN. MINIMUM HORIZONTAL SEPARATION BETWEEN PARALLEL WATER MAINS AND SEWER PIPES (INCLUDING MANHOLES AND VAULTS) SHALL BE 10 FEET MEASURED FROM THE OUTSIDE OF THE PIPES, MANHOLES OR VAULTS.

2. STORM

2.1 REGULATIONS - STORM SEWERS AND APPURTENANCES SHALL BE CONSTRUCTED IN CONFORMANCE WITH THE LATEST REGULATIONS OF THE MUNICIPALITY AND ALL THERMOPLASTIC PIPE SHALL BE INSTALLED IN ACCORDANCE WITH ASTM D-2321.

2.2 MATERIALS - THE CONTRACTOR MAY USE THE FOLLOWING PIPE MATERIAL FOR THE MAIN SEWER AS ALLOWED BY THE MUNICIPALITY, PROVIDING THAT THE ROUGHNESS COEFFICIENT (N FACTOR) IS 0.013 OR BETTER:
 

- HIGH DENSITY CORRUGATED POLYETHYLENE PIPE (PE), AASHTO M-294, TYPE S, ASTM D-3350.

2.3 TESTING - UPON COMPLETION OF SYSTEM INSTALLATION, THE MAIN SEWER SYSTEM AND LEADS TO STRUCTURES SHALL BE FLUSHED AND LAMPED TO THE SATISFACTION OF THE MUNICIPALITY.

UTILITY NOTES (CONT.)

3. WATER

3.1 WATER SERVICE LINES SHALL BE CONSTRUCTED IN ACCORDANCE WITH THE REGULATIONS AND SPECIFICATIONS OF THE WATER AUTHORITY.

3.2 WATER SERVICE LINES SHALL HAVE A MINIMUM OF FIVE FEET OF COVER FROM FINISHED GRADE IN LAWN AREAS AND SIX FEET OF COVER FROM FINISHED GRADE IN PAVED AREAS.

3.3 WATER SERVICE LINES SHALL BE SEPARATED AT LEAST TEN FEET, MEASURED FROM THE OUTSIDE OF THE PIPES, FROM SEWER MAINS OR SEPTIC SYSTEMS.

3.4 WATER SERVICE LINES SHALL BE IDENTIFIED AS:

DESCRIPTION	SIZE	MATERIAL (a)	TYPE (b)
PRIVATE PORTION: FROM THE CONTROL VALVE TO THE METER	6"	D.I.P.*	6"

(a) ACCEPTABLE MATERIAL IS "CLASS 52 CEMENT MORTAR LINED DUCTILE IRON PIPE.  
(b) SERVICE TYPES INCLUDE: DOMESTIC = DS, FIRE = FS, OR COMBINED = CMB

3.5 WATER SERVICE LINES SIZED 4-INCHES OR GREATER SHALL BE:

- PRESSURE TESTED IN ACCORDANCE WITH THE LATEST SPECIFICATIONS OF THE MONROE COUNTY WATER AUTHORITY. A WATER AUTHORITY REPRESENTATIVE MUST WITNESS THIS TEST.
- DISINFECTED BY USING THE CONTINUOUS FEED METHOD ACCORDING TO ANWA STANDARD SPECIFICATIONS. AFTER FLUSHING AND DISINFECTING THE SERVICE LINE, WATER SAMPLES SHALL BE COLLECTED BY THE MONROE COUNTY DEPARTMENT OF HEALTH. APPROVAL AND NOTIFICATION BY THE HEALTH DEPARTMENT OF PASSING HEALTH SAMPLE TEST(S) MUST BE RECEIVED BEFORE THE SERVICE WILL BE ACTIVATED BY THE WATER AUTHORITY.

PROJECT STATISTICS

1. GENERAL:

1.1 PROPERTY OWNER - DIMARCO PERINTON SQUARE, LLC

1.2 PROPERTY ADDRESS - 6720 PITTSFORD-PALMYRA ROAD FAIRPORT NY 14450

1.3 TAX ACCOUNT - 166.172-24

2. ZONING REGULATIONS:

2.1 ZONING DISTRICT -

- C - COMMERCIAL
- RESTAURANTS ARE A PERMITTED USE WITHIN THE C DISTRICT.
- DRIVE-THRU FACILITIES ARE PERMITTED THROUGH A PERMIT GRANTED BY THE BOARD OF APPEALS
- OUTSIDE DINING IS ALLOWED WITH PLANNING BOARD APPROVAL.

2.2 CODE REQUIREMENTS - TABLE OF REQUIREMENTS

	REQUIRED	PROVIDED
MINIMUM LOT SIZE	40,000 SF	23.5 ACRES
FRONT SETBACK	85'	72'
SIDE SETBACK	30'	82'
REAR SETBACK	30'	N/A
MIN. GREEN SPACE	35%	42% (1.6 ACRE DEVELOPMENT AREA ONLY)
MAX. BUILDING COVERAGE	30%	10% (1.6 ACRE DEVELOPMENT AREA ONLY)
LANDSCAPING BUFFER	50'	14'
PARKING REQUIREMENTS	21	45

\* EXISTING NON-CONFORMING CONDITION WITH NO PROPOSED CHANGES.

3. PARCEL STATISTICS:

3.1 AREA - 23.5 ACRES (TOTAL PLAZA)  
1.6 ACRES SPECIFIC TO THE PROJECT

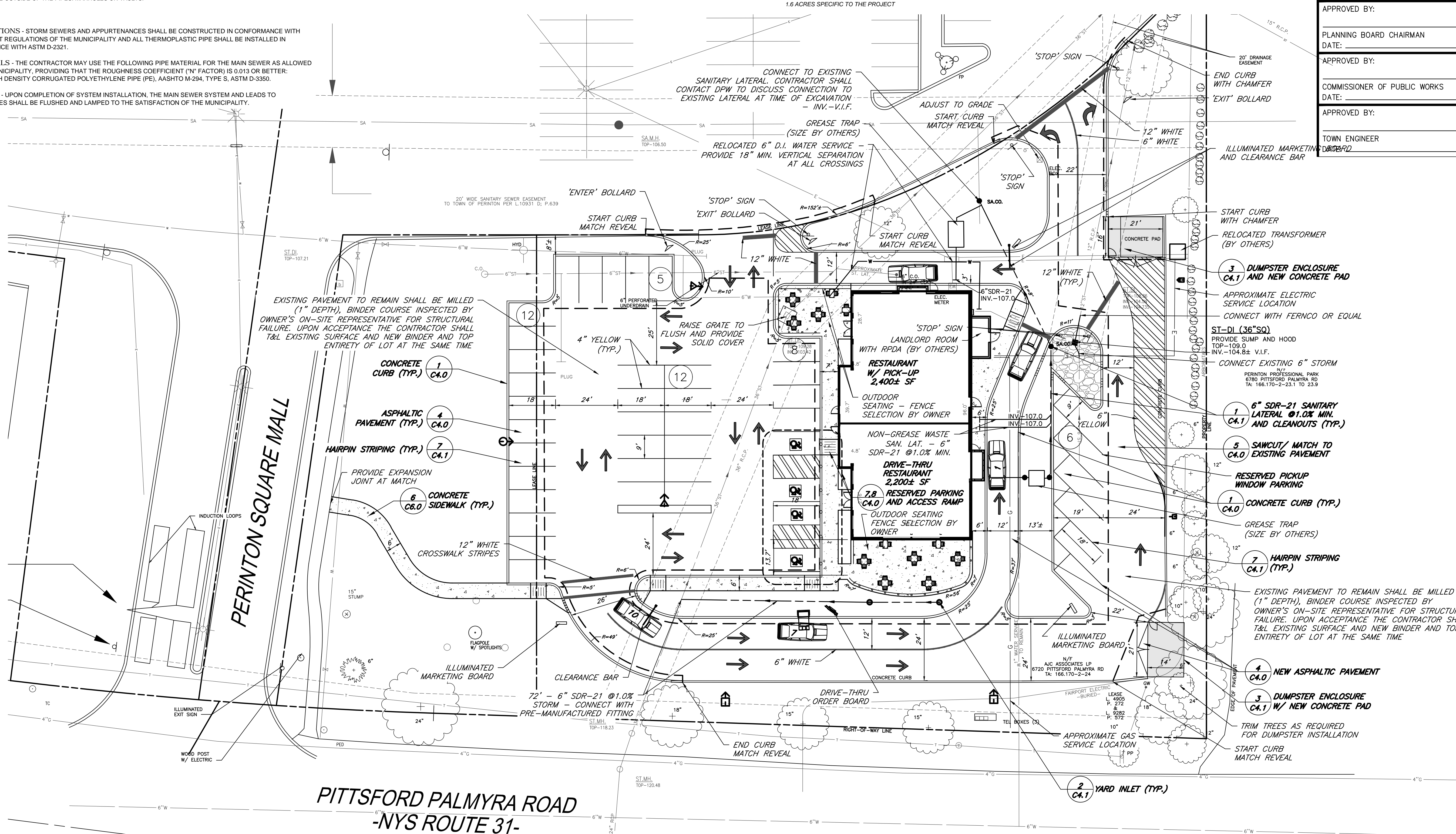

APPROVED BY:

PLANNING BOARD CHAIRMAN  
DATE:

APPROVED BY:

COMMISSIONER OF PUBLIC WORKS  
DATE:

APPROVED BY:

TOWN ENGINEER

**MARATHON ENGINEERING**  
ROCHESTER LOCATION  
39 CASCADE DRIVE  
ROCHESTER, NY 14614  
585-458-7770  
ITHACA LOCATION  
840 HANSHAW RD, STE 12  
ITHACA, NY 14850  
607-241-2917  
www.marathoneng.com

PRELIMINARY / FINAL SITE PLANS  
for  
**RETAIL BUILDING CONVERSION**  
**DIMARCO GROUP**  
6720 PITTSFORD PALMYRA ROAD (NYS ROUTE 31)  
MONROE COUNTY STATE OF NEW YORK

JOB NO: 0861-20  
SCALE: 1"=20'  
DRAWN: MPT  
DESIGNED: MPT  
DATE: 05/11/18

REVISIONS

DATE	BY	REVISION
07/20/20	MT	TOWN COMMENT

STATE OF NEW YORK  
ROBERT P. BRINGLEY  
LICENSED PROFESSIONAL ENGINEER  
NO. 924  
EXPIRES 12/31/2024

DRAWING TITLE:  
**SITE AND UTILITY PLAN**

2 of 6  
SHEET No: **C1.0**  
JOB No: 0861-20  
DRAWING No:

File: Z:\Engineering\Job Files\Starbucks\0861-17\Drawings\Starbucks\0861-17 Plans - Starbucks.dwg, Last saved: 7/22/2020, Plot Date: 7/22/2020, By: MTOMLINSON, Plot Style: ---